

Lock valve

Check valve

$Q_{max} = 10 \text{ gpm}$, $p_{max} = 5000 \text{ psi}$
poppet type, hydraulically operated
Type series: CVPF-08-...



- Screw-in cartridge valve
- For cavity C0820
- All external parts zinc plated, chromited (CrVI-free)
- Installation in threaded port body type B0820
- Wide selection of bias springs allows flexibility for back-pressure application

Description

This unit is a screw-in cartridge style, guided poppet, hydraulic check valve, for use as a blocking or load holding device for high pressure applications. This

valve allows free flow from port 1 to port 2 and blocks flow from port 2 to port 1 or holding a load.

Symbol



Technical data

General characteristics	Description, value, unit
Function group	Lock valve
Function	Check valve
Design	Screw-in cartridge valve
Controls	hydraulically operated
Characteristic	poppet type
Construction size	NG 5 / SAE 08
Thread size	3/4-16 UNF-2A
Mounting attitude	unrestricted

General characteristics	Description, value, unit
Weight	0.15 lb
Cavity acc. factory standard	For cavity C0820
Tightening torque steel	37.5 ft·lb
Tightening torque aluminium	27.5 ft·lb
Tightening torque tolerance	± 5 %
Minimum ambient temperature	- 22 °F
Maximum ambient temperature	+ 248 °F
Surface protection	All external parts zinc plated, chromited (CrVI-free)
Sealing material	see ordering code
Seal kit order number	NBR: SKN-0821/ FKM: SKV-0821

Hydraulic characteristics	Description, value, unit
Maximum operating pressure	5000 psi
Maximum flow rate	10 gpm
Flow direction	see symbol
Hydraulic fluid	All general purpose hydraulic fluids such as MIL-H-5606, SAE-#10, SAE-#20, etc.
Minimum fluid temperature	- 13 °F
Maximum fluid temperature	+ 176 °F
Viscosity range	10 ... 500 mm ² /s (cSt)
Recommended viscosity range	15 ... 250 mm ² /s (cSt)
Minimum fluid cleanliness (cleanliness class according to ISO 4406:1999)	class 18/16/13
Internal leakage flow rate	5 drops/min maximum at 5000 psi

Performance graphs

measured with oil viscosity 28.5 mm²/s (cSt)

$\Delta p = f(Q)$ Pressure drop-flow rate characteristic

Δp [psi (bar)]

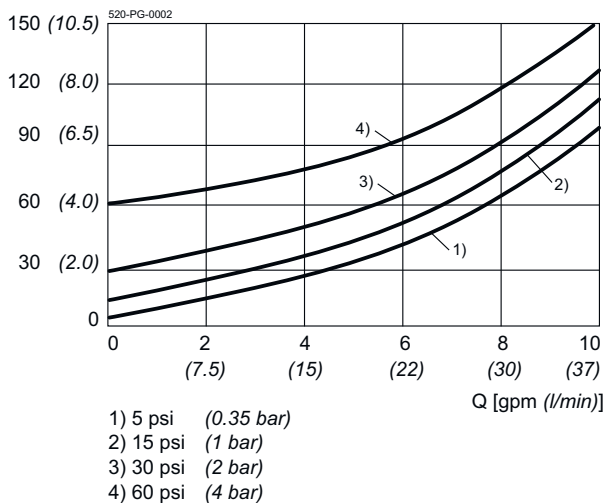

Dimensions and sectional view

Beispiel für die Masseinheit:
Example for the dimensional units:

.031 = 0.031" inch
(0.79) = 0.79 mm millimeter

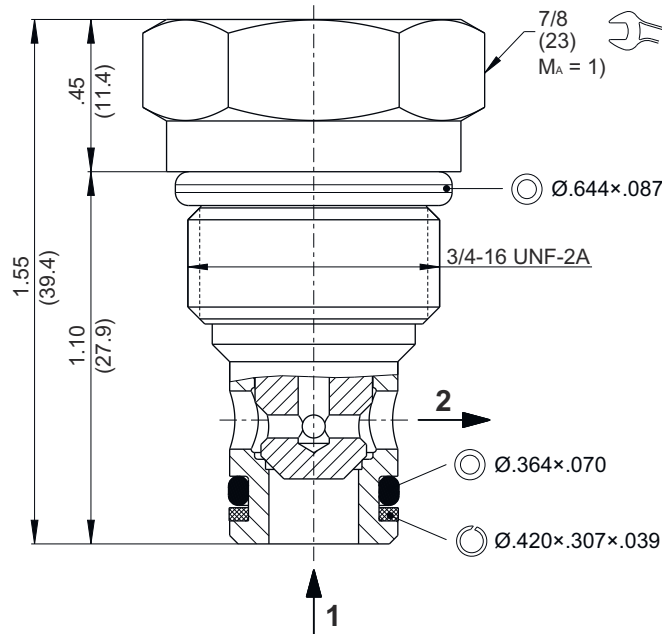

Installation information



ATTENTION!

Only qualified personnel with mechanical skills may carry out any maintenance work. Generally, the only work that should ever be undertaken is to check, and possibly replace, the seals. When changing seals, oil or grease the new seals thoroughly before fitting them.



NOTE!

The seals are not available individually. The seal kit order number can be found in the chapter "Technical data".



NOTE!

1) When fitting the screw-in cartridge valve, use the specified tightening torque. The value can be found in the chapter "Technical data".

Ordering code

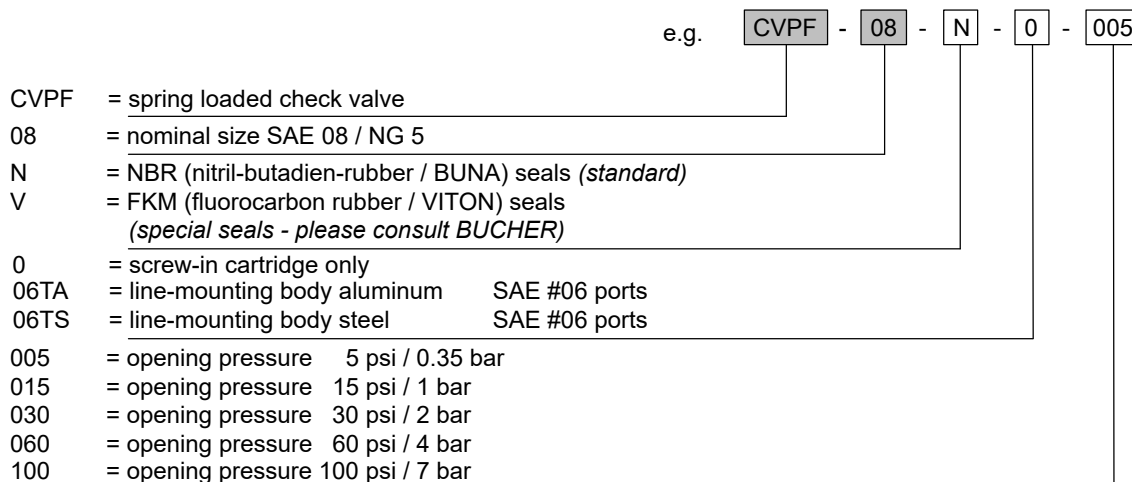

Related data sheets

Reference	Description
520-P-000050	Form tools
520-P-000110	Cavity Cavity C0820
520-P-000111	Threaded port body B0820

info.us@bucherhydraulics.com

www.bucherhydraulics.com

© 2024 by Bucher Hydraulics Inc., Elgin, IL 60124, USA

All rights reserved.

Data is provided for the purpose of product description only, and must not be construed as warranted characteristics in the legal sense. The information does not relieve users from the duty of conducting their own evaluations and tests. Because the products are subject to continual improvement, we reserve the right to amend the product specifications contained in this catalogue.